



# Denman

The Denman offers an exciting hexagonal floor plan with expansive Great Room encompassing kitchen, dining and living areas under a vaulted open beam cathedral ceiling, surrounded by glass and centered on an open fireplace. Wings on either side of the Great Room contain a Master Bedroom with bathroom and a two bedroom plus bathroom combination respectively.

Floor Plan:

**Denman**

Model No:

**5817**

Total Area:

**161.21 m<sup>2</sup>**

Width:

**23.49 m**

Depth:

**13.8 m**

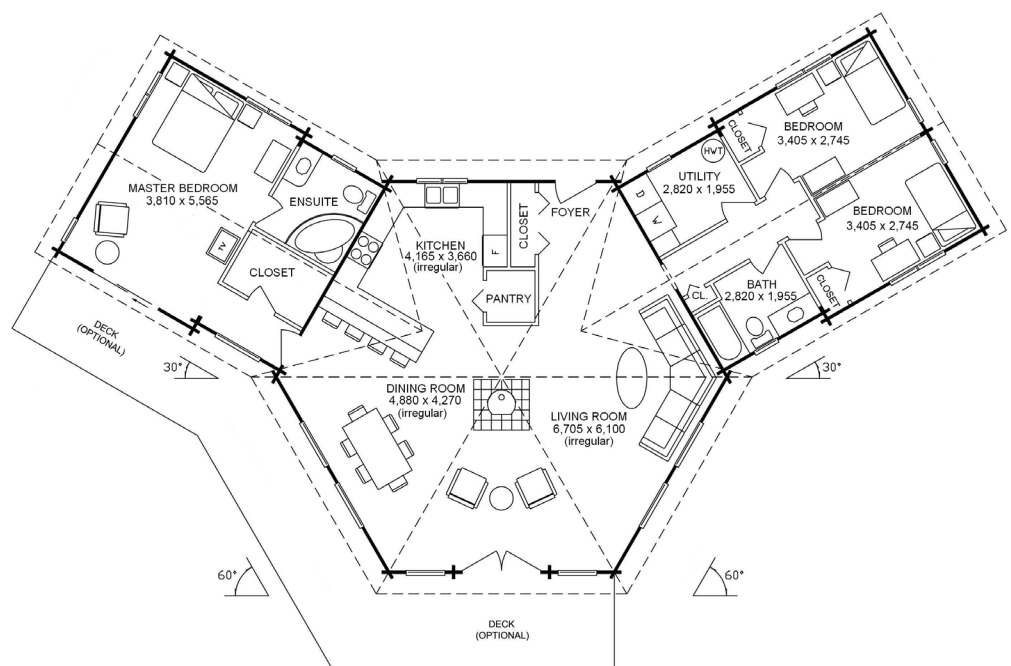

MAIN FLOOR

**161.21 m<sup>2</sup>**

