



Lakewood

A fabulous home for entertaining with an open plan encompassing dining room, family room and living room all around a unique central fireplace. The Master Bedroom includes a walk-in closet, bathroom and powder room. The Lakewood is a perfect home for gatherings with family and friends.

Floor Plan:

Lakewood

Model No:

1580

Total Area:

157.54 m²

Width:

19.2 m

Depth:

10.5 m

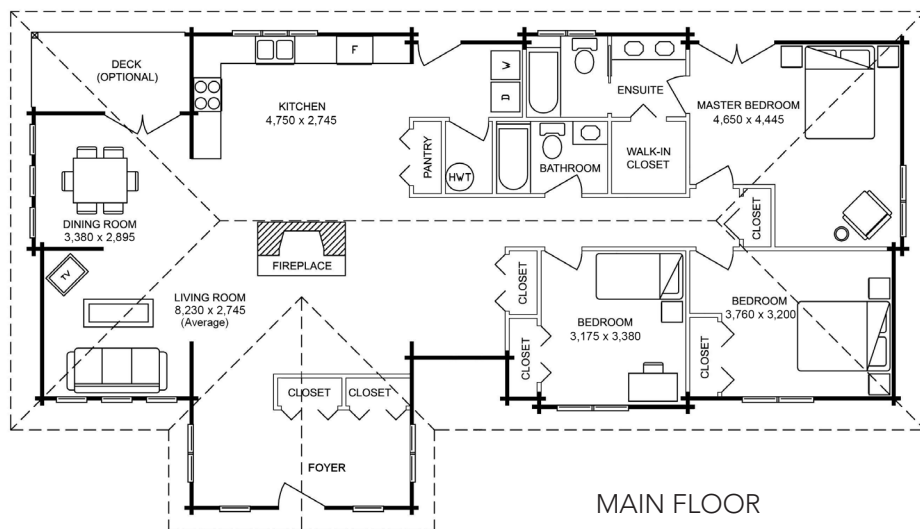

MAIN FLOOR
157.54 m²

