



Vermont

An elegant home distinguished by vast areas of glass and expansive decks. The spacious gourmet kitchen features a large eating nook and Family Room. The Master Bedroom includes a bathroom and walk-in closet with French doors leading onto a deck or garden setting. Formal living and dining rooms, two bedrooms on the upper level and a grand entrance make the Vermont a spectacular place to call home.

Floor Plan:

Vermont

Model No:

2001

Total Area:

216.33 m²

Width:

17.57 m

Depth:

12.65 m

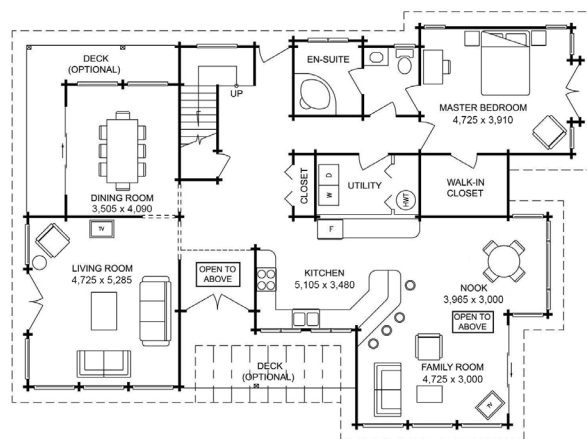

MAIN FLOOR
164.51 m²

UPPER FLOOR
51.82 m²

